

City of Northampton, MA: Commercial Property Record Card

[New Search](#) [Property Type Classification Code Reference](#) Card 1 of 1

Parcel - Location - Zoning - Assessment

Map-Block-Lot: 24D-329-001	Zoning:	Assessment:
Location: 203 KING ST	Neighborhood: 303	Land: 425,270
#Living Units: 0	Deed Book: 7231	Building: 566,630
Class: C-326	Deed Page: 191	Total: 991,900

Building Information

Bldg #:	1
Year Built:	1975
# of Units:	0
Quality Grade:	B+
# Efficiencies:	0
# 1-Bedroom:	0
# 2-Bedroom:	0
# 3-Bedroom:	0
Covered Parking:	0
Uncovered Parking:	0
Total Unadj RCN:	180,440
Total Unadj RCNLD:	455,500
Grade Factor:	1.35
# Ident Units:	1
Func/Econ Factor:	1
RNCLD:	455,500

Building Sketch

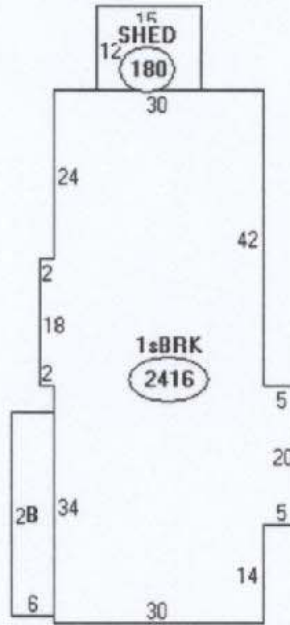

Descriptor/Area
A: 1sBRK 2416 sqft
B: 1sGLASS 174 sqft
C: SHED 180 sqft

Attached Improvements				
Type	Meas-1	Meas-2	Meas-3	# Units
CP6	164 0		1	1
CP6	84 0		1	1
CP6	48 0		1	1
RS1	180 0		1	1

Detail Information:

Levels	Use	Ext Walls	Heat	AC	% Good	Unadj RCN
- 01	100	Brick Stone	Hot Air	Central	85	180,440

Land Data

Outbuilding Info

Square Foot Type		
Type	SQ Feet	Value
Prime Site	22,527	425,270

Utilities
All Public

Acreage Type		
Type	Acres	Value

Street/Road
Paved
Sidewalk

Descr	Width	Length or Size	Quan	Yr Built	Phys Cond	Func Util	% Good	Value
PA1	0	13000	1	1977	Normal	Normal	0	17,880
LT3	0	0	8	1977	Normal	Normal	0	5,540
AP1	0	420	1	1977	Normal	Normal	0	4,850
MS1	0	2000	1	1977	Normal	Normal	0	2,000

Other Improvements: MS1= LARGE SIGN Total Value: 30,270

no
information

Curb/Gutter

Sales Info

Date	Type	Price	Validity
09/30/1998	Land + Bldg	910,000	C

Permit Info

Date	Permit #	Price	Purpose
no information			